

Little Qualicum Falls Provincial Park

Located 19 kilometres west of Parksville off Hwy 4, this 440-hectare park straddles Little Qualicum River where impressive waterfalls crash and plummet down a rocky gorge in a forest setting. Shaded riverside trails and picnic facilities along Cameron Lake make Little Qualicum a favoured destination. To the west is world-renowned Cathedral Grove in MacMillan Provincial Park, the gateway to the Alberni Valley and the open coast beaches of Pacific Rim National Park. To the east are the sunny, sandy beaches of the Parksville-Qualicum area.

Things to Do



Day-use area with picnic tables, picnic shelter, flush toilets and parking area.



Pit toilets are available in this park. Flush toilets are available from April 15 to October 15.



There are 6 kilometres of walking trails throughout the park with a loop trail viewing the lower and upper waterfalls. Please obey the posted signs and keep to designated trails.



River fishing is permitted with a valid fishing license. Closures are posted in the park.



The river is closed for swimming between the park boundary below the lower bridge to 75 metres above the middle bridge due to waterfalls and rapids. Those wanting to swim should visit Cameron Lake day-use area.



Riverbanks can be slippery, stay away from cliff and riverbank edges. Jumping from bridges or cliffs is prohibited.

Visit www.bcparks.ca for more information

Visitor Services



Campground has 96 private sites. No electrical hookups are available.



There are no sani-station/dump facilities at this park. The closest station is available at Rathtrevor Beach Park and a fee is charged for the service.



Campsites in the lower campground, flush toilets and some pit toilets are wheelchair accessible.



Cold water taps are located throughout the park. Taps are shut off during the off season.

Special Notes

Park regulations protect the natural state of the park and ensure a quality experience for all visitors.

- Park open all year, no services provided in winter.
- Fires are permitted in designated fire rings only. Visitors may bring firewood or purchase at park.
- Pets must be on a leash at all times. Please be responsible for their behaviour and waste.
- Check in: 1pm for reservations; 7am - 10pm for non-reservations. Checkout: 11am. Gate open: 7am - 11pm.
- Bicycles must be kept to roadways. No cycling on trails.
- Take valuables with you when leaving vehicle or lock them in a secure location when leaving the campsite.

Contact Information

Park Operator: R.L.C Enterprize Ltd.
Phone: 250.474.1336
Email: office@rlcparks.ca

Reservations: Discover Camping
Phone: 1-800-689-9025
Online: www.discovercamping.ca

Visit www.bcparks.ca for more information

Updated Aug 15

Little Qualicum Falls Provincial Park

Park Map and Information Guide



BRITISH
COLUMBIA

BC Parks

Little Qualicum Falls Provincial Park

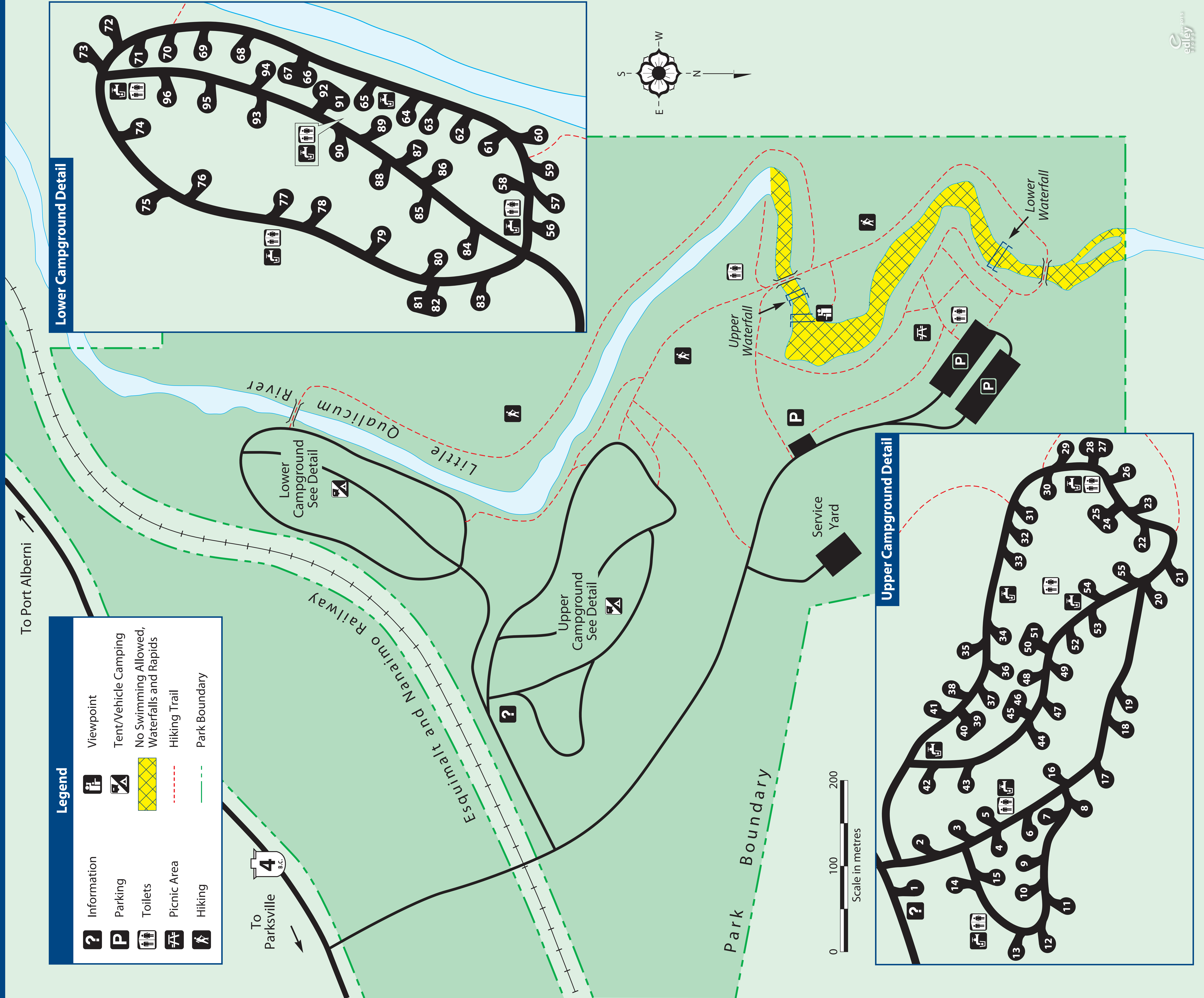

Legend	
Information	Viewpoint
Parking	Tent/Vehicle Camping
Toilets	No Swimming Allowed, Waterfalls and Rapids
Picnic Area	Hiking Trail
Hiking	Park Boundary

Lower Campground Detail

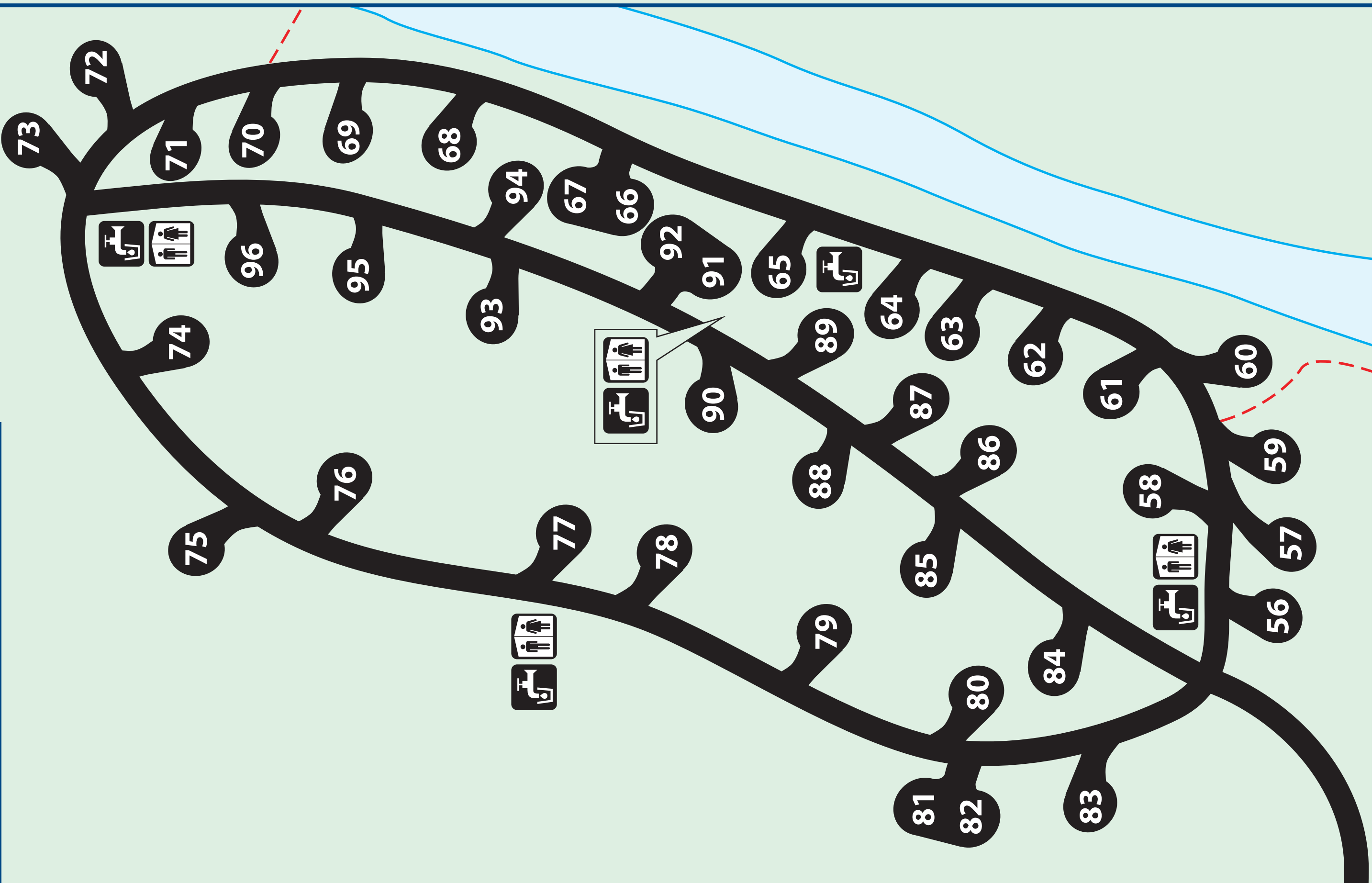

Upper Campground Detail

